



LEADSUN

PBOX[®] X3

Bluetooth/Bluetooth Speaker Version
蓝牙/蓝牙音响版

User Manual
使用说明书

LEADSUN (International) Ltd.

Add.: NO.1 Pingdong 1st Rd,
Nanping Science & Technology Industrial Park,
Zhuhai, Guangdong, China. P.O.: 519060
Tel.: +86-0756-2289712 Fax: +86-756-8682090
sales@leadsunglobal.com

珠海麟盛电子科技有限公司
地址: 珠海市南屏工业科技园屏东一路一号
邮编: 519060
电话: 400-0756-966 传真: 86-756-8682090
电子邮箱: sales@leadsun.com.cn



Thank you for choosing LEADSUN PBOX X3 Integrated Solar Light.

If you have any question, please consult our customer service sales@leadsunglobal.com.

LEADSUN (International) Ltd. reserves the rights to amend and improve the product appearance, function and construction without any prior notification.

Please make the object as standard in case of any difference in description.

LEADSUN guarantees that the User Manual has been approved well, but won't bear the responsibility for any loss.

Contents

Product Maintenance & Disposal 3

 1.1 Cautions 3

 1.2 Disposal 4

User Manual 4

 2.1 Instructions 4

 2.2 Technical Data 5

 2.3 Packing List 6

 2.4 Installation Instructions 8

 2.5 APP Operation Illustration 12

Trouble-shooting 13



1. Product Maintenance & Disposal

1.1 CAUTIONS:

Please carefully read the following directions when you use the PBOX X3 integrated solar light in order to avoid damage or malfunction.

- Do not drop this product or drop any item thereon.
- Do not immerse this product in the water.
- Do not use any detergent that contains ammonia, benzene or abrasant to avoid any damage to the product.
- Only use software provided by LEADSUN so to avoid malfunction.
- For long-term storage, batteries need to be recharged every 3 months to maintain battery life.
- When installing, keep away from the shadow of trees, building and etc., so as to avoid the damage to the solar panel.
- For high performance, regularly apply the neutral detergent with a damp cloth and gently clean the surface of the solar panel.
- For products installed with water base, please bring the products back indoors during storms or strong wind (31 mile/h or above), so as to avoid unexpected damage to the products and pedestrians.
- Children are forbidden to climb or play with the lamp post for safety reasons.

Operating and Storage Temperature

The discharge temperature ranges from -4°F to 140°F (-20°C - 60°C).

Recharge at a temperature between 32°F to 140°F (0°C - 60°C).

The controller will automatically stop charging in order to protect the battery if the temperature drops below 32°F (0°C) or rises above 140°F (60°C).

Please ensure not to install this products in the area where the extreme temperature conditions exceed its limits.

In cold areas, please select the products equipped with heating system. However, the operating hour shortens due to the cold weather.

Store the products at a temperature between 32°F to 95°F (0°C-35°C)

Modification:

It is not on the term of warranty if client does modify & refit the light leading to non-proper working without authorization of LEADSUN.

Replacement of Parts / Spare Parts:

If you need information or if you have a problem, please visit the LEADSUN website at www.leadsglobal.com or contact your local distributor / dealer.

1.2 Disposal:

Our product is made of recyclable high-performance materials and components. Do not throw away the appliances with the normal household waste at the end of their life, but hand them in at an official collection point for recycling. By doing this, you help to preserve the environment.

Please refer to local laws & regulations involved in classified collection of electrical products and electrons. Properly-disposing of the wastes can helpfully avoid potential negative influence to environment and human health.

2. User Manual

2.1 Introduction

With elegant and smooth design, PBOX X3 Smart Solar Lamp provides brightness over 400lm. You can easily control the brightness, work mode and operation of the lamp via APP on your smart phone. The special designed telescoping lamp pole unit is not only easy to install, but also bring you so much convenience and fun.

PBOX X3 Bluetooth speaker even surprises your experience with enhanced dual stereo.

PBOX X3 invites you to enter into a new everyday life of efficiency, convenience and delight.

PBOX X3 Functions:

1. Three operating modes: automatic On and OFF, customized and manual control via APP on your cellphone.
2. Recharged by solar panels, or via Micro USB port (USB cable and AC/DC adaptor not included).
3. High-performance lithium battery can sustains 12+ operating hours for the LED lamp, or 4+ hours for the Bluetooth speaker.
4. Recharge mobile phones, tablets and other potable electronic devices.
5. Customize operating mode according to local weather.
6. Look up charging current and historical charging and discharging data.
7. Play music (PX3BL only).

Caution: Items 5, 6 and 7 are applicable via LIVESUN APP. LIVESUN APP is compatible with Android 4.0 and above, and iPhone 4s, iPad 2, iPad mini and above.



2.2 Technical Data

Model No.		PX3B	PX3BL
Physical Specification			
Solar Panel		12W/9V	12W/9V
IP Rate		IP65	IP65
Lithium Battery		50 Wh	50 Wh
Power of Speaker		N/A	12W
Charging Output		5V 2A max	5V 2A max
Heating Function		Optional	Optional
Net Weight		6.6lb (3.0 kg)	7.9lb (3.6 kg)
Body Size		476×276×86 mm	476×276×86 mm
3m Lamppost		Optional	Optional
Charging / Discharging Time			
Discharging Time		Full bright: ≥12hours	12+ hours for LED or 4+ hours for speaker
Charging Time	Charged by Solar panel ⁽¹⁾	6hrs	6hrs
	Charged by Micro USB ⁽²⁾	10hrs	10hrs
Light Output			
Luminous Flux		>400 lm	>400 lm
LED		Samsung	Samsung
Visual Angle		120°	120°
Color Temperature		4000k	4000k
Environment Rating			
Working Temp.	Charge Temp.	32°F to 140°F (0°C~+60°C)	32°F to 140°F (0°C~+60°C)
	Discharge Temp.	-4°F to 140°F (-20°C~+60°C)	-4°F to 140°F (-20°C~+60°C)
Battery Storage Temp.		-4°F to 140°F (-20°C~+60°C)	-4°F to 140°F (-20°C~+60°C)
Package			
Main Body G.W.		7.7lb (3.5 kg)	9.5lb (4.3 kg)
PBOX X3 Suite G.W.		20.0lb (9.2 kg)	22.0lb (10 kg)
Box Size of PBOX X3		480×320×140 mm	480×320×140 mm
Box Size of PBOX X3 Suite		920×385×215 mm	920×385×215 mm
Instructions			
Recommended Installation Height Range		3-4m	3-4m
Recommended Installation Distance of Poles Range		8-10m	8-10m

(1). Working time data as above are based on 8 hours of charging in good sunny days in summer, measured at the latitude 22°, east longitude 113°. Actual working time might be different according to difference of area, season, environment and direction.

(2). USB charger output: 5V 1A

2.3 Packing list

Please confirm that you have received goods as follows (Item #3 #4 #5 #6 are components for the lamppost which need to purchase separately.):

1. Main body
2. Back Stand
3. Lamppost
4. Base Pin
5. Lamppost Kit Bracket
6. Water Base
7. Anti-theft Spanner
8. User Manual

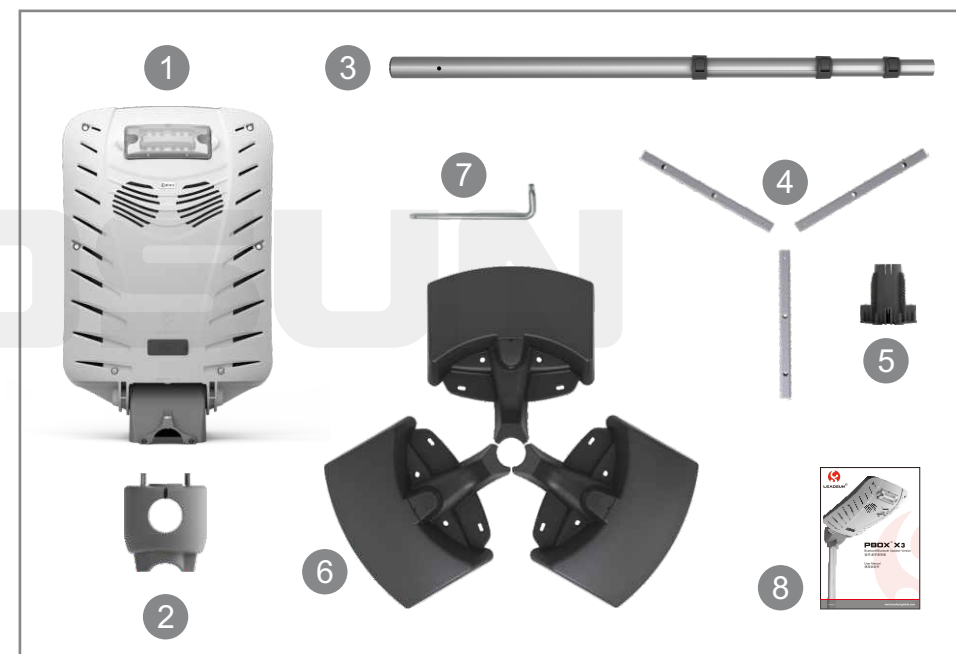

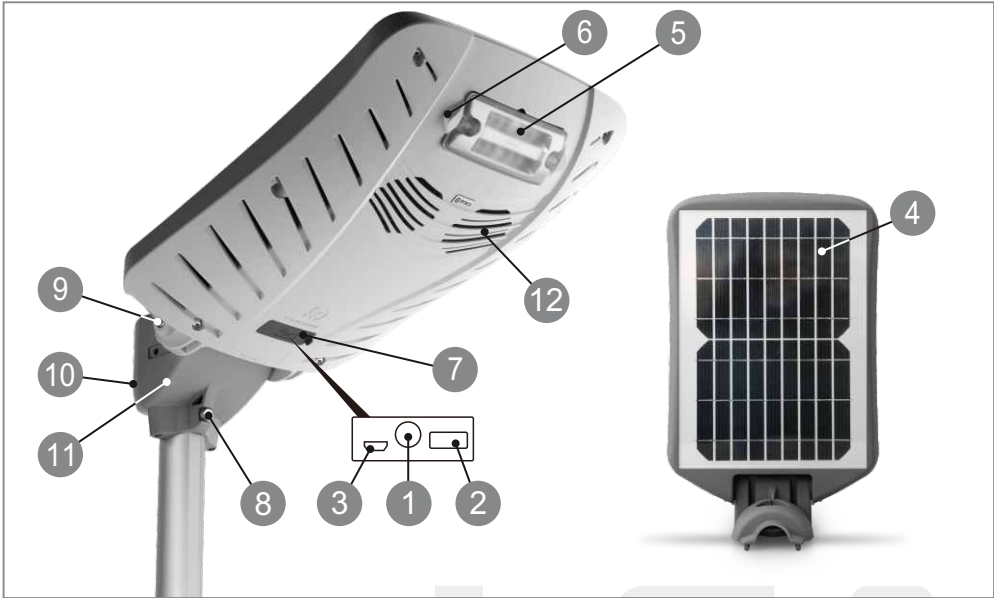

No.	Name	Brief of Function
1	Switch	Turn ON/OFF the PBOX X3 system
2	USB	Charge for external devices
3	Micro USB	Charge for PBOX X3 (PX3S model without micro USB)
4	Solar Panel	Charge for PBOX X3
5	LED Module	Illuminate
6	M4×15 Screw	Fix LED module
7	Rubber Lid	For waterproof purpose
8	M6×50 Screw	Fix PBOX X3 onto the lamppost
9	M6×30 Screw	Adjust angle of LED module
10	Back Stand	Use jointly with lamp frame
11	Lamp Frame	Prop main body
12	Water-proof Speaker (PX3BL only)	Playing music



2.4 Installation Guide

Open the package and take the PBOX X3 out.

Open the Rubber Lid at the bottom and press Power Switch (switch 1, as shown in the picture on the left). Put the rubber lid back on after that so the product stays waterproof. Light should be on if you cover the solar panel at this time.

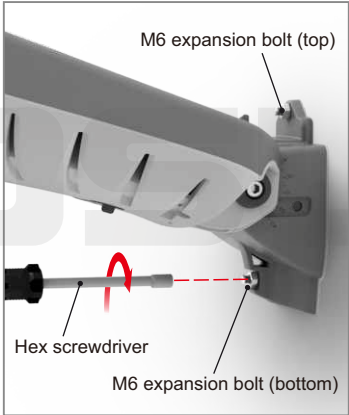

Type A: Wall-mount the Lamp

Use a $\Phi 8$ drill bit and make two holes on the wall. Put two M6 expansion bolts into the holes. Place the lamp on the wall by fastening the expansion bolts with a hex screwdriver (as seen in the picture on the left).

Tips: For the best performance of the solar panel, try to fix the lamp as close to the top of the wall as possible when installing.



Type B: Stand the Lamp on the Ground

Insert the back stand into the lamp frame to stabilize the lamp (as shown in the picture on the left).

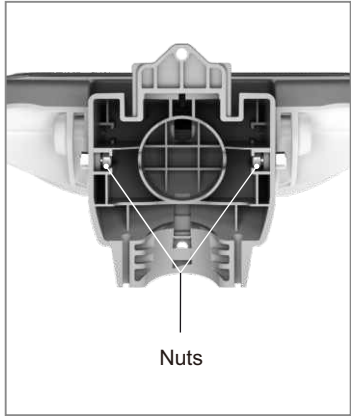

Type C: Install Lamp on an Arm Pole

C1. Find two holes on both sides of the frame. Place two nuts individually into the slots. Insert the screws through the holes and secure the nuts (as shown in the picture on the left).

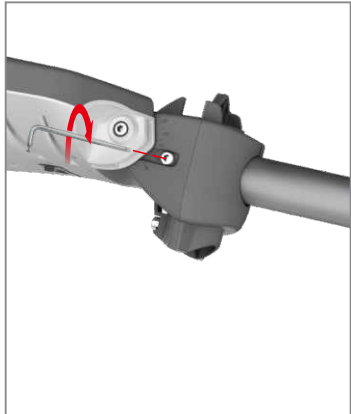

C2. Inset the lamp base in the frame, and then insert the arm pole into the lamp frame. Fasten the screws with the Anti-theft Spanner (as shown in the picture on the left).

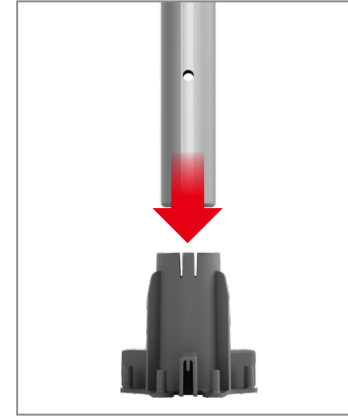

Type D: Install with LEADSUN Optional Lamp Post.

D1. Insert the lamp pole into the bracket. Make sure to match the holes on the lamp pole with the snap joints on the base.

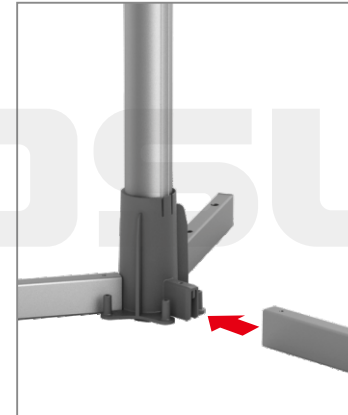

D2. Joint the bracket with three pins at the corresponding, and tighten them by screws (as shown in the picture of the left).



D3. Fill the Water Base with water.

Place three Water Base unto the base pins to stabilize the lamp post (as shown in the picture on the left).



D5. Place the lamp onto the pole.

Match the hole on the lamp with the hole on the pole, and insert the screw in.

Fasten the screw and secure the lamp on the pole (as shown in the picture on the left).

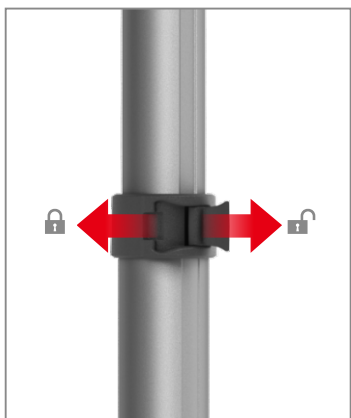

D6. Fix the pole.

Pull the extendable pole out and then fasten the tightener from top to bottom (as shown in the picture on the left).

Caution: be careful when pulling extendable pole out as well as pushing it back into place.

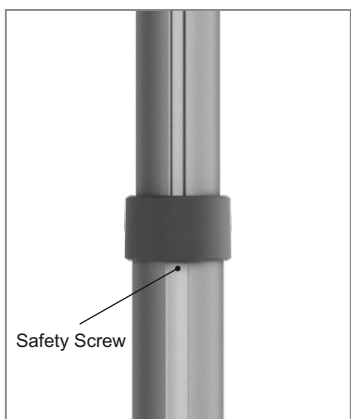

D7. Children are forbidden to play with the lamp post.

To prevent any accident caused by a loose tightener, please place and fasten a safety screw underneath the tightener on the bottom of the lamp pole.

E. Angle Adjustment illustration:

E1. Solar panel angle adjustment: loosen two M6 screws on both sides of main body, and adjust it to suitable position and lock screws.

E2. LED module angle adjustment: turn the LED module to suitable position with your finger. (Refer to the below figure)



2.5 APP Operation Illustration

To control PBOX X3 through mobile phone, you should install LIVESUN APP as per the below steps.

A. Iphone: please search "LIVESUN" in "APP Store", and then clicks to install.

B. Andriod Phone: please log in www.leadsglobal.com or related software platform, and then download LIVESUN APP and install.

You can do the below through APP:

1. Register a member.
2. Control the light.
3. Inquire historical data.
4. Set working mode.
5. Real-time supervision.
6. Music playing (PX3BL only).
7. Micophone (PX3BL only).

For further details, please kindly check 'Use Guide' under 'other functions' in the APP.

3. Troubleshooting

No.	Problems	Checking steps	Solutions
1	The light wouldn't turn on.	Check if the power switch is ON.	Turn on the power switch.
		Check if the solar panel is shaded.	Remove the items covered the solar panel, or relocate the lamp to an unshaded position.
		Check if the solar panel is under a strong light source.	Remove the light sources, or relocate the lamp to avoid the light source.
		Check the APP on your phone, and see if the power button is OFF.	Press the power button to turn on the light.
		Use the real-time self-checking on your APP for troubleshooting.	Contact the manufacturer for maintenance after troubleshooting.
2	Extremely short operating time at night.	Check if the lamp is under any shade caused by trees, buildings and etc.	Remove the items covered the solar panel, or relocate the lamp to an unshaded position.
		Check if the solar panel is covered with dust or other items.	Clean the surface of the solar panel, or remove the items covered the solar panel.
		Check if the operating mode set on your APP is correct.	Reset the working mode to reduce the lamp power or operating time.
		Use the real-time self-checking on your APP for troubleshooting.	Contact the manufacturer for maintenance after troubleshooting.

No.	Problems	Checking steps	Solutions
3	Would't charge mobile devices.	Check if the USB charging cable is broken.	Replace the USB charging cable.
		Use the APP to check the power level of the battery.	Recharge the PBOX X3 if the power level of the battery is low.
		Use the real-time self-checking on your APP for trouble-shooting.	Contact the manufacturer for maintenance after troubleshooting.
4	Bluetooth connection failed.	Check if your phone has installed the LIVESUN APP.	Install the LIVESUN APP.
		Check if the power switch (switch 1) is ON.	Turn on the power switch (switch 1).
		Restart the lamp.	Press the power switch (switch 1) to turn off the lamp. Wait for 10s to restart the lamp.
		Check if it is out of battery.	Recharge the PBOX X3.
5	Music playing function is failed. (PX3BL only)	Check if your phone has Installed the LIVESUN APP.	Install the LIVESUN APP.
		Check if the power switch (switch 1) is ON.	Turn on the power switch (switch 1).
		Use the APP in your phone to check with the history data.	Feedback the latest history data to the manufacturer for further analysis.

感谢您使用麟盛公司出品的PBOX X3一体化太阳能灯。

如有疑问请拨打客户服务热线400-0756-966咨询。

麟盛保留对产品性能、结构和外观进行改进而无需任何通知的权利。如有描述同实物不一致的情形，请以实物为准。

麟盛保证本说明书的内容已经被努力校对过，并不承担由此带来的任何形式的损失。

目录

产品维护与回收17

 1.1 注意事项17

 1.2 产品回收18

使用说明19

 2.1 概述19

 2.2 型号参数20

 2.3 包装清单21

 2.4 安装说明23

 2.5 APP操作说明28

故障处理29

LEADSUN

1. 产品维护与回收

1.1 注意事项

以下是对于您在使用PBOX X3一体化太阳能灯时的几点注意事项，请仔细阅读，以避免造成损坏或故障：

- 切勿跌落本产品或让物体跌落在产品上。
- 切勿让本产品浸入水中。
- 切勿使用含有氨水、苯或研磨剂的清洁剂，因为它们会损害本产品。
- 仅使用LEADSUN所提供的软件来管理，以免发生问题。
- 如果长期存放本产品，须每隔3个月拿出来充电一次，以保持电池寿命。
- 安装本产品时需要远离树木、建筑物等阴影，否则有可能损坏太阳能组件。
- 建议定期用湿布或使用中性的清洁剂来清理太阳能组件表面，以免影响它的发电效率。
- 使用水座安装的产品，遇到大风暴（7级或以上的风速），请收回本产品，以免被吹倒损坏或伤人。
- 禁止小孩玩弄或攀爬灯杆，以免造成伤害。
- 请了解当地的关于声音管制规定，控制好音量。

操作温度和存放温度

- 本产品的放电温度范围在-20℃至60℃；充电温度范围在0℃至60℃。当温度低于0℃或超过60℃，控制器会自动停止充电以保护电池；请确认灯具安装地的极限工作温度不会超出以上范围。在低温地区，请选购具有加热功能（可在-20℃至60℃范围内充电）的产品型号，但在低温情况下工作时间会相应缩短。
- 请在常温介于0℃至35℃之间的环境中存放产品。

修改

未经LEADSUN授权，如用户擅自修改和改装产品而导致产品不能正常工作，将不在保修范围内。

更换部件/配件

要订购更换部件/配件，请访问：www.leadsun.com.cn，或者联系当地经销商。

1.2 产品回收

本产品采用可回收利用的高性能材料和组件制造而成。切勿将本品与其它生活垃圾一起处理。

请自行了解当地关于分类收集电子和电气产品的规定，正确弃置旧产品有助于避免对环境和人类健康造成潜在的负面影响。

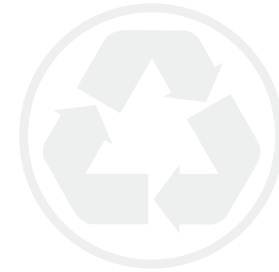

2. 使用说明

PBOX X3智能太阳能灯，具有优美流畅的外型和拥有超过400lm的光效, 并可以通过手机APP随意调控灯具亮度，改变工作模式，以及查看工作状态。而精心制作的伸缩式灯杆套件，不仅安装极其简便，更是一道亮丽的风景。

PBOX X3蓝牙音响版具有双声道音效，其明亮通透的音色让人忘情。

让PBOX X3走进你的生活，创造美妙难忘的户外时光。

PBOX X3蓝牙及蓝牙音响版具有以下特性：

- 1) 具备三种开关灯模式：自动光控开关（天黑亮灯，天亮关灯）；按预设的自定义模式开关灯；通过APP手动开关灯及调光。
- 2) 太阳能充电，或通过Micro USB接口对X3充电（不带AC/DC适配器及USB线）；
- 3) 内置超大容量铁锂电池可供LED灯工作12小时以上或蓝牙音响工作4小时以上；
- 4) 对手机、平板电脑等移动数码设备充电；
- 5) 根据当地气候为灯具定义你自己的工作模式；
- 6) 查看在线或历史的充放电数据；
- 7) 播放音乐（仅适合蓝牙音响版）；

注：5，6，7项功能需通过LIVESUN APP实现。LIVESUN APP支持安卓4.0以上版本的手机，或IPHONE 4S, IPAD 2, IPAD MINI以上的机型。

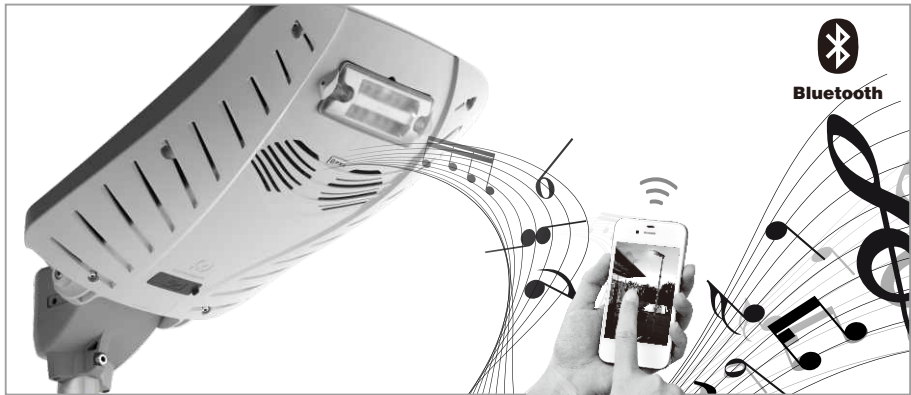

2.2 型号参数

型号		PX3B (蓝牙版)	PX3BL (音响版)
规格			
太阳能板		12W/9V	12W/9V
防护等级		IP65	IP65
锂电池		50 Wh	50 Wh
喇叭额定功率		无	12W
充电输出		5V 2A max	5V 2A max
加温功能		选配	选配
灯体净重量		3.0 kg	3.6 kg
灯体尺寸		476×276×86 mm	476×276×86 mm
3米灯杆高度		选配	选配
充/放电时间			
放电时间		全亮12小时	全亮照明12小时以上或音乐播放4小时以上。
充电时间	太阳能充电 ⁽¹⁾	6小时	6小时
	Micro USB充电 ⁽²⁾	10小时	10小时
光输出			
光通量		>400 lm	>400 lm
LED灯珠		Samsung	Samsung
视角		120度	120度
色温		4000k	4000k
环境参数			
工作温度	充电温度	0℃~+60℃	0℃~+60℃
	放电温度	-20℃~+60℃	-20℃~+60℃
存储温度		-20℃~+60℃	-20℃~+60℃
产品包装			
单灯包装毛重		3.5 kg	4.3 kg
套装毛重(含灯杆)		9.2 kg	10 kg
单灯包装尺寸		480×320×140 mm	480×320×140 mm
套装包装尺寸		920×385×215 mm	920×385×215 mm
安 装			
建议安装高度范围		3-4m	3-4m
建议布灯间距范围		8-10m	8-10m

(1). 工作时间是在晴朗夏季得出的数据，测于北纬22° 东经113° 实际工作时间可能因安装地域、季节、环境、方向等不同而有变化。

(2). 使用输出功率为5V 1A的充电器。

2.3 包装清单

请确认您已收到以下物品（非套装产品不包含3、4、5、6项）：

- 1. 灯体
- 2. 后座
- 3. 灯杆
- 4. 管脚
- 5. 灯杆支架
- 6. 水座
- 7. 梅花防盗板手
- 8. 使用说明书

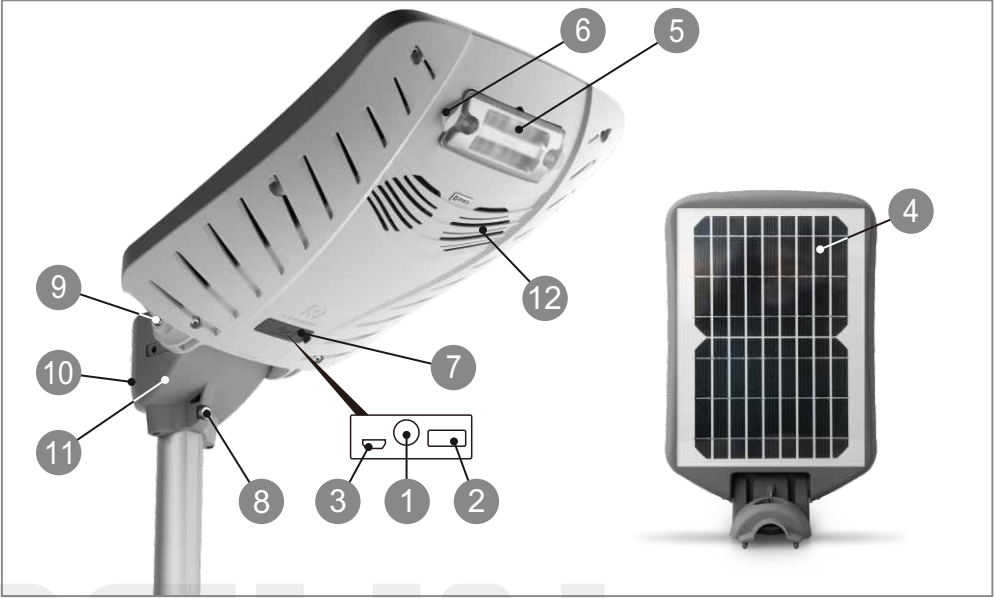
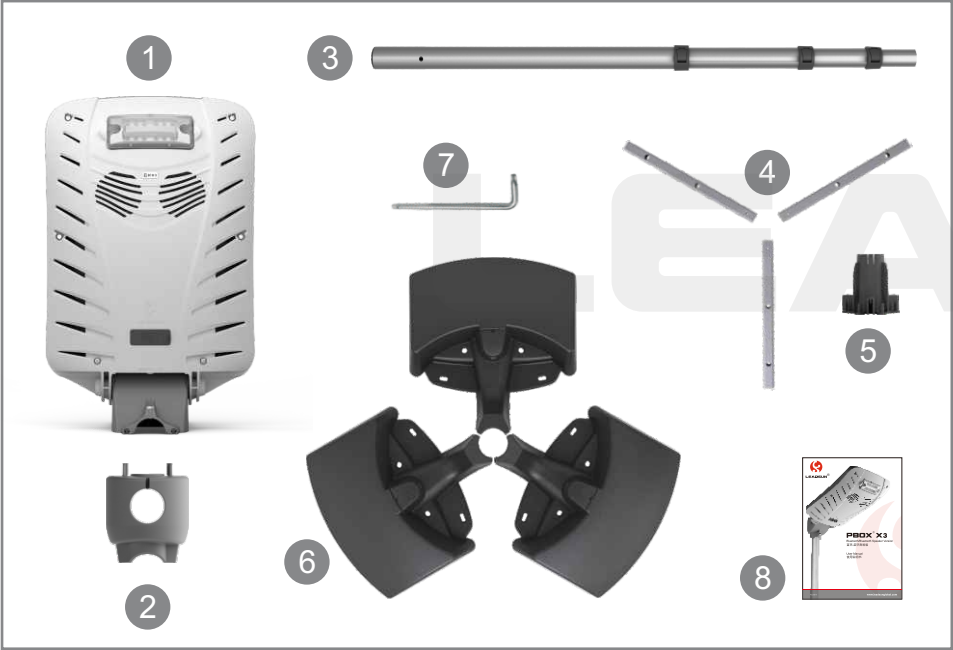

序号	名称	简要功能说明
1	开关	打开或关闭电源
2	USB	对USB设备充电
3	Micro USB	对PBOX X3充电
4	太阳能板	对PBOX X3充电
5	LED灯	照明
6	M4 × 15螺丝	用于固定LED灯
7	橡胶盖	用于接口防水
8	M6 × 50螺丝	将PBOX X3固定于灯杆上
9	M6 × 30螺丝	用于调整灯体角度
10	后座	与灯体支架11配合使用
11	灯体支架	支撑灯体
12	防水喇叭（仅PX3BL型号）	音乐播放



2.4 安装说明:

打开包装，取出灯体；打开橡胶盖，按下开关#1启动灯具。盖上橡胶盖，以保持防水作用（见左边示意图）。此时遮挡太阳能板灯亮。

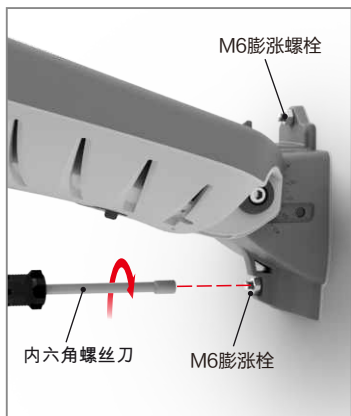

A. 墙壁安装方式说明:

用 $\Phi 8$ 钻头在墙壁打好孔，装入M6膨胀螺栓，再固定灯体，见左边示意图。

注意：安装于墙面时，尽可能接近墙面顶端，确保太阳能电池板能充分接收阳光。



B. 垂直放置说明:

如左图所示，把后座接入灯体支架，支撑灯体立起。

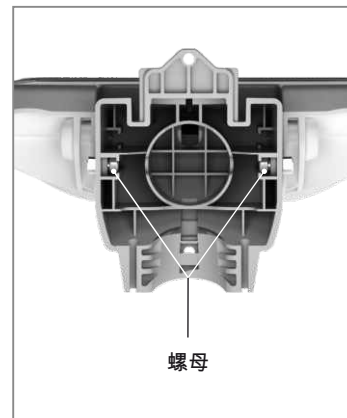

C. 横杆安装方式说明:

C1. 将两个螺母分别放入支架内两侧，用螺丝锁住螺母，见左边示意图。

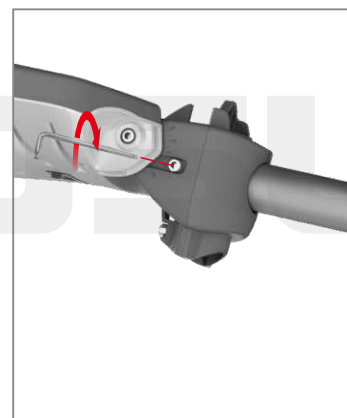

C2. 将后座插入支架，再插入横杆，用梅花扳手锁紧两侧螺丝即可，见左边示意图。

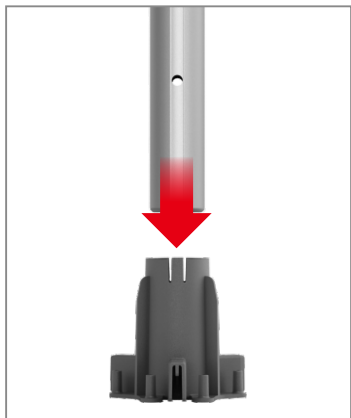

D. 选配灯杆安装方法说明:

D1. 把灯杆插入到灯杆支架中，注意灯杆孔位要对准支架扣位，见左边示意图。

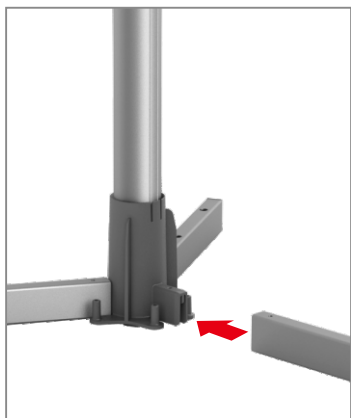

D2. 把3个管脚插入到灯杆支架对应的位置中，见左边示意图。



D3. 把灌好水的水座套在脚架上，使灯杆立稳，见左边示意图。



D5. 插入灯杆，注意孔位对准螺丝位，锁紧螺丝即可，见左边示意图。

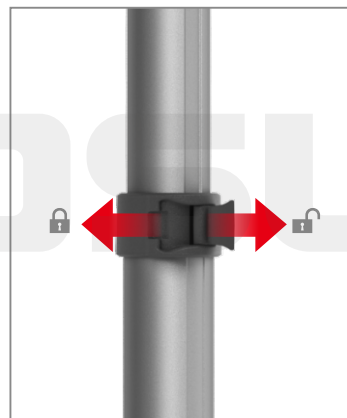

D6. 打开锁紧扣，拉出灯杆再锁紧拉扣。从上至下依次操作，见左边示意图。
注：拉伸或收回灯杆时请注意安全。



D7. 禁止小孩玩弄或攀爬灯杆。为防止儿童打开锁紧扣发生意外，请在最下面一节锁紧扣处锁上安全螺丝，见左边示意图。

安全螺丝孔

E. 角度调节说明:

E1. 太阳能板角度调节: 用扳手松开两边的M6螺丝, 然后上下推动灯体到合适的位置, 再锁紧螺丝即可。

E2. LED灯角度调节: 用手指上下推动LED灯到合适的位置即可, 见下图示。

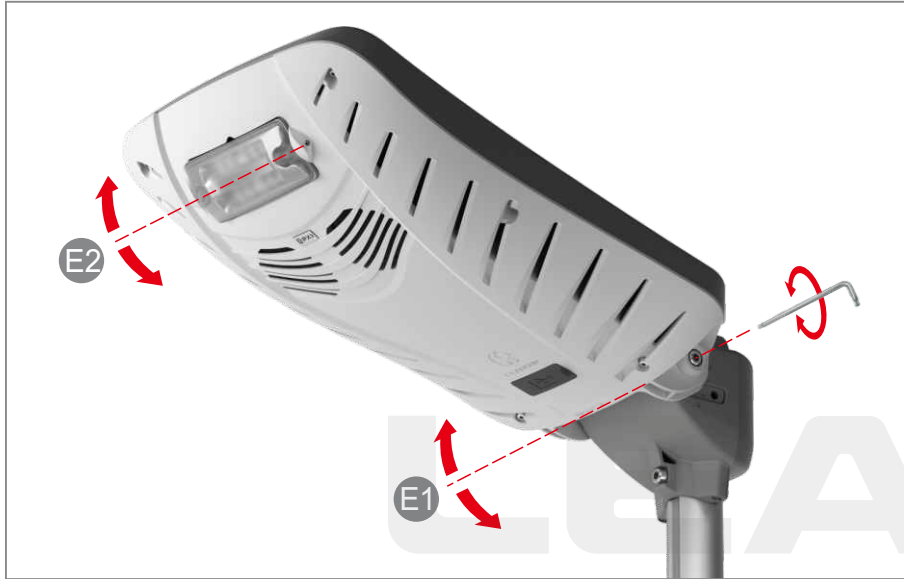

2.5 APP操作说明

请使用LEADSUN设计的APP来控制灯具, 下载软件使用下面路径。

A. 苹果手机请在“APP Store”中搜索“LIVESUN”, 点击安装。

B. 安卓手机请登陆www.leadsglobal.com或相关软件平台, 下载LIVESUN APP并安装。

通过APP您可以进行如下操作:

1. 注册成为会员。
2. 照明控制。
3. 历史数据查询。
4. 工作模式设置。
5. 实时查看功能。
6. 音乐播放功能 (仅PX3BL型号具有此功能)。
7. 麦克风功能 (仅PX3BL型号具有此功能)。

详细操作说明请查看软件中的“其它功能”下的“使用教程”。

3. 故障处理

序号	不良现象	检查步骤	处理方法
1	晚上不亮灯。	检查开关是否按下。	按下开关。
		检查太阳能板是否被遮挡。	清除遮挡物或更换灯具安装位置。
		检查太阳能板是否有较强的光源照着。	移开光源或更改灯具安装位置。
		检查手机软件中开关灯按键是否关闭。	打开APP中开关按键。
		使用APP软件查看历史数据。	发送最新历史数据记录给厂商分析。
2	晚上亮灯时间严重不足。	产品安装的位置是否被房屋或树荫等阴影遮挡。	清除遮挡物或更换灯具安装位置。
		太阳能板表面积尘或有覆盖物。	清洁太阳能板表面。
		检查手机软件自定义的工作模式设置是否合理。	改为更省电的工作模式。
		使用APP软件查看历史数据。	发送最新历史数据记录给厂商分析。
3	不能对手机或平板电脑充电。	检查USB充电线是否损坏。	更换USB充电线。
		通过手机软件查看电池电量。	如果电量不足，需充电。
		使用APP软件查看历史数据。	发送最新历史数据记录给厂商分析。
4	蓝牙连接失败。	检查手机是否安装LIVESUN软件。	安装该软件。
		检查开关是否按下。	按下开关。
		重启灯具。	关闭电源开关，等待10秒后再重启。
		检查电池是否没电。	给灯具充电。
		如上述办法均无效。	请联系经销商维修。
5	不能播放音乐(仅限于PX3BL型号)。	检查手机是否安装LIVESUN软件。	安装该软件并使用该软件播放。
		检查灯具的开关1是否按下。	按下开关。
		使用APP软件查看历史数据。	发送最新历史数据记录给厂商分析。

Customer Information: _____ Tel: _____

Address: _____ E-mail: _____

Product Name	Series No.
Model No.	
Warranty Period Limited	
Dealers Name and Seal	
	Checking Code

Note: _____
